

| APPROVAL | SIGN | DATE |
|----------------|------|------|
| TOOLING MGR | | |
| ENGG MGR | | |
| OPERATIONS MGR | | |

FIGURE 1

FOR REVISION UPDATE PLEASE REFER TO HISTORY OF CHANGES.

Carsem Your Technology Partner

REV
C

| | |
|--------------------------|--------|
| DWG NO: - MLPM-CPOD-0006 | |
| APP'D | - |
| CHECKED | CC YIP |
| DESIGNED | - |
| DRAWN | KC LAU |

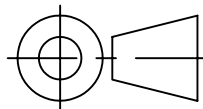

FILE:- MLPM-CPOD-0006-RevC

MLP MICRO
PACKAGE OUTLINE
(COL)

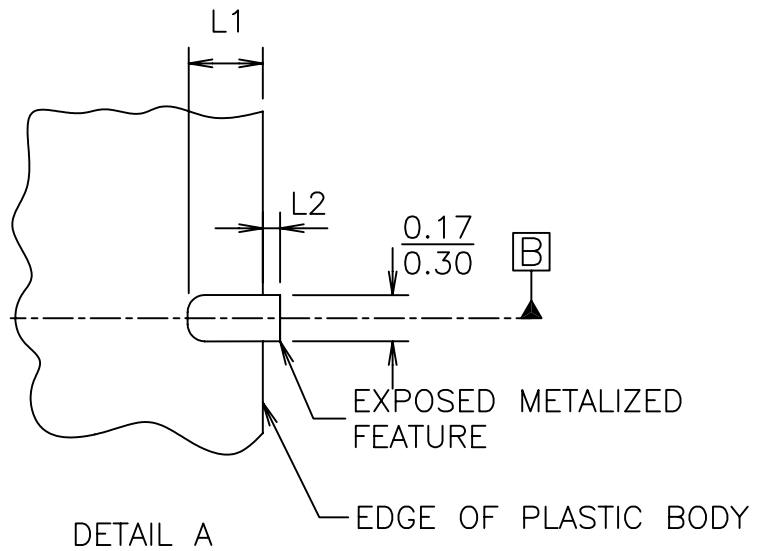
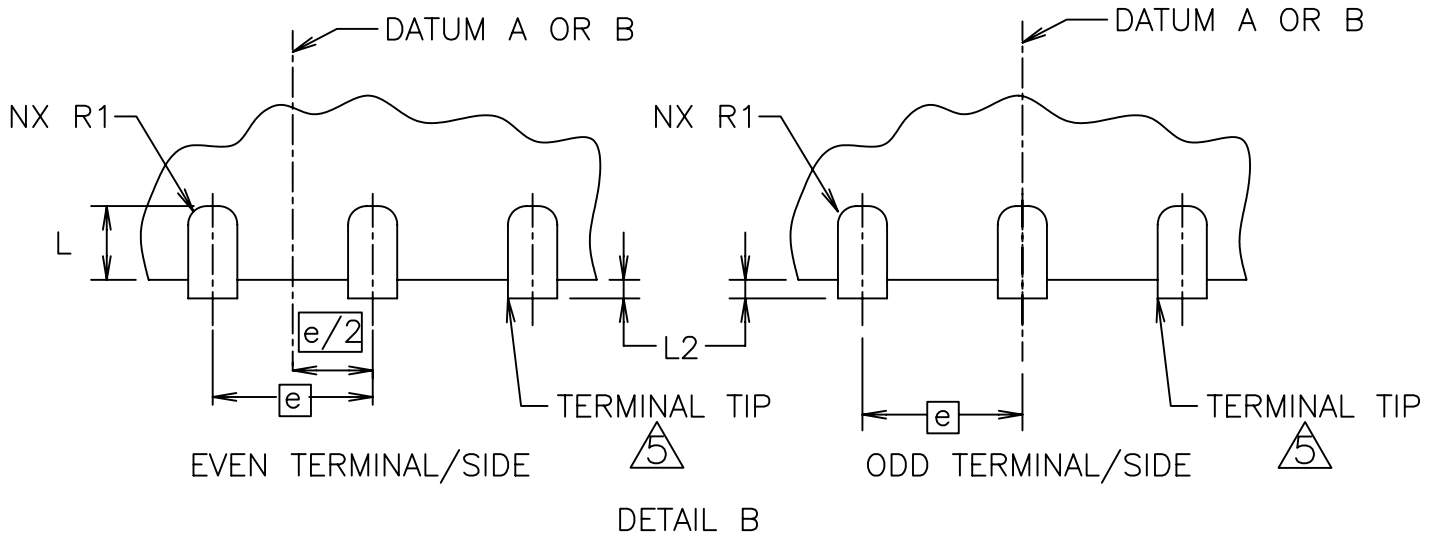

THIS FEATURE APPLIES TO BOTH ENDS OF THE PKG.

FOR REVISION UPDATE PLEASE REFER TO HISTORY OF CHANGES.

 Carsem Your Technology Partner

REV
C

| | |
|----------|------------------|
| DWG NO: | - MLPM-CPOD-0006 |
| APP'D | - |
| CHECKED | CC YIP |
| DESIGNED | - |
| DRAWN | KC LAU |

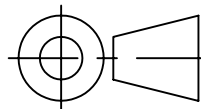

FILE:- MLPM-CPOD-0006-RevC

MLP MICRO
PACKAGE OUTLINE
(COL)

PAGE : 2 of 7

TABLE 1



| VARIATION DESIGNATORS | | | | | | | |
|-----------------------|-------------|-------------------|-------------|------------------|-------------|-------------------|-------------|
| FIRST DIGIT CODE | | SECOND DIGIT CODE | | THIRD DIGIT CODE | | FOURTH DIGIT CODE | |
| OVERALL HEIGHT | | BODY LENGTH | | BODY WIDTH | | TERMINAL PITCH | |
| A | LETTER CODE | D | LETTER CODE | E | LETTER CODE | e | LETTER CODE |
| 1.0 MAX | V | 1.0 | A | 1.0 | A | 0.95 | A |
| | | 1.5 | B | 1.5 | B | 0.65 | C |
| | | 2.0 | C | 2.0 | C | 0.50 | D |
| | | 2.5 | D | 2.5 | D | | |
| | | 3.0 | E | 3.0 | E | | |

TABLE 2: TOLERANCE OF FORM AND POSITION

| PITCH (MM) SYMBOL | 0.95 | 0.65 | 0.50 |
|----------------------|------|------|------|
| aaa | 0.10 | 0.10 | 0.10 |
| bbb | 0.10 | 0.10 | 0.10 |
| ccc | 0.10 | 0.10 | 0.10 |
| ddd | 0.05 | 0.05 | 0.05 |
| NOTES | 1,2 | | |
| REF | | | |
| ISSUE | | | |



FOR REVISION UPDATE PLEASE REFER TO HISTORY OF CHANGES.

 Carsem Your Technology Partner

REV
C

| | |
|----------|------------------|
| DWG NO: | - MLPM-CPOD-0006 |
| APP'D | - |
| CHECKED | CC YIP |
| DESIGNED | - |
| DRAWN | KC LAU |

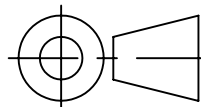

| |
|---------------------------------------|
| FILE:- MLPM-CPOD-0006-RevC |
| MLP MICRO PACKAGE OUTLINE (COL) |
| PAGE : 3 of 7 |

TABLE 3: COMMON HEIGHT DIMENSION

V-PROFILE HEIGHT

| DIM SYMBOL | MIN | NOM | MAX |
|---------------|------|-------|------|
| A | 0.80 | 0.90 | 1.00 |
| A1 | 0 | 0.025 | 0.05 |
| A2 | 0.65 | 0.70 | 0.75 |
| A3 | 0.15 | 0.20 | 0.25 |
| θ | 0° | 10° | 12° |
| NOTES | 1,2 | | |
| REF | | | |
| ISSUE | | | |

TABLE 4: COMMON TERMINAL DIMENSIONS

| DIM PITCH | b | | | R1 | L2 |
|--------------|------|------|------|-------|-------|
| | MIN | NOM | MAX | REF | MAX |
| 0.50 | 0.20 | 0.25 | 0.30 | 0.100 | 0.125 |
| NOTES | 5,12 | | | | |
| REF | | | | | |
| ISSUE | | | | | |

FOR REVISION UPDATE PLEASE REFER TO HISTORY OF CHANGES.

 Carsem Your Technology Partner

REV
C

DWG NO: - MLPM-CPOD-0006

| | |
|----------|--------|
| APP'D | - |
| CHECKED | CC YIP |
| DESIGNED | - |
| DRAWN | KC LAU |

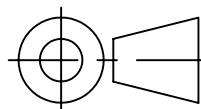

FILE:- MLPM-CPOD-0006-RevC

MLP MICRO
PACKAGE OUTLINE
(COL)

PAGE : 4 of 7

⑨ SUMMARY TABLE 5

| BODY SIZE (mm) | LEAD PITCH (mm) | LEAD COUNT | VERY THIN PROFILE |
|----------------|-----------------|------------|-------------------|
| 3.00 X 3.00 | 0.50 | 10 | VEED-3V |
| | | | |
| | | | |
| | | | |
| | | | |
| | | | |
| | | | |

FOR REVISION UPDATE PLEASE REFER TO HISTORY OF CHANGES.



REV
C

| | |
|--------------------------|--------|
| DWG NO: - MLPM-CPOD-0006 | |
| APP'D | - |
| CHECKED | CC YIP |
| DESIGNED | - |
| DRAWN | KC LAU |

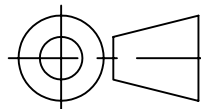

| |
|---------------------------------|
| FILE:- MLPM-CPOD-0006-RevC |
| MLP MICRO PACKAGE OUTLINE (COL) |
| PAGE : 5 of 7 |

SUMMARY TABLE 5 0.50mm PITCH VARIATION

| SYMBOL | | | | | | | | | | NOTE |
|--------|---------|--|--|--|--|--|--|--|--|------|
| D BSC | 3.00 | | | | | | | | | |
| E BSC | 3.00 | | | | | | | | | |
| L MIN | 0.45 | | | | | | | | | |
| L NOM | 0.58 | | | | | | | | | |
| L MAX | 0.65 | | | | | | | | | |
| L1 MIN | 0.20 | | | | | | | | | |
| L1 NOM | 0.29 | | | | | | | | | |
| L1 MAX | 0.45 | | | | | | | | | |
| N | 10 | | | | | | | | | 3 |
| ND | 5 | | | | | | | | | 6 |
| R2 REF | 0.075 | | | | | | | | | |
| VARV | VEED-3V | | | | | | | | | |
| NOTE | 1,2,9 | | | | | | | | | |
| REF | | | | | | | | | | |
| ISSUE | | | | | | | | | | |

FOR REVISION UPDATE PLEASE REFER TO HISTORY OF CHANGES.

 **Carsem** Your Technology Partner

REV
C

| | |
|--------------------------|--------|
| DWG NO: - MLPM-CPOD-0006 | |
| APP'D | - |
| CHECKED | CC YIP |
| DESIGNED | - |
| DRAWN | KC LAU |

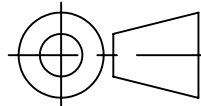

| |
|---------------------------------------|
| FILE:- MLPM-CPOD-0006-RevC |
| MLP MICRO PACKAGE OUTLINE (COL) |
| PAGE : 6 of 7 |

Note:

1. Dimensioning and tolerancing conform to ASME Y14.5M-1994.
2. All dimensions are in millimeters . All angles are in degrees.
3. N is the total number of terminals.
4. The terminal #1 identifier and terminal numbering convention shall conform to JESD 95-1 SPP-012. Details of terminal #1 identifier are optional , but must be located within the zone indicated. The terminal #1 identifier may be a molded, marked, or metalized features.
5. Dimensions b apply to metallized terminal and is measured between 0.15 and 0.20mm from terminal tip.
6. ND refer to the maximum number of terminals on D side.
7. Depopulation of terminals is allowed and will be called out on the individual variations.
8. Variation VEEA is shown for illustration only.
9. For a complete set of dimensions for each variation, see the individual variation and the common dimensions and tolerances on page 4 & 5.
10. Coplanarity applies to the exposed heat sink slug as well as the terminals.
11. Profile tolerance (aaa) will be applicable only to the plastic body, and not to the metalized features (such as the terminal tips and tie bars.) Metallized features may protrude a maximum of L2 from the plastic body profile.
12. Corner will be sharp unless otherwise specified with radius dimensions.

FOR REVISION UPDATE PLEASE REFER TO HISTORY OF CHANGES.

 Carsem Your Technology Partner

REV
C

DWG NO: - MLPM-CPOD-0006

| | |
|----------|--------|
| APP'D | - |
| CHECKED | CC YIP |
| DESIGNED | - |
| DRAWN | KC LAU |

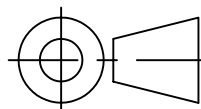

FILE:- MLPM-CPOD-0006-RevC

MLP MICRO
PACKAGE OUTLINE
(COL)

PAGE : 7 of 7